

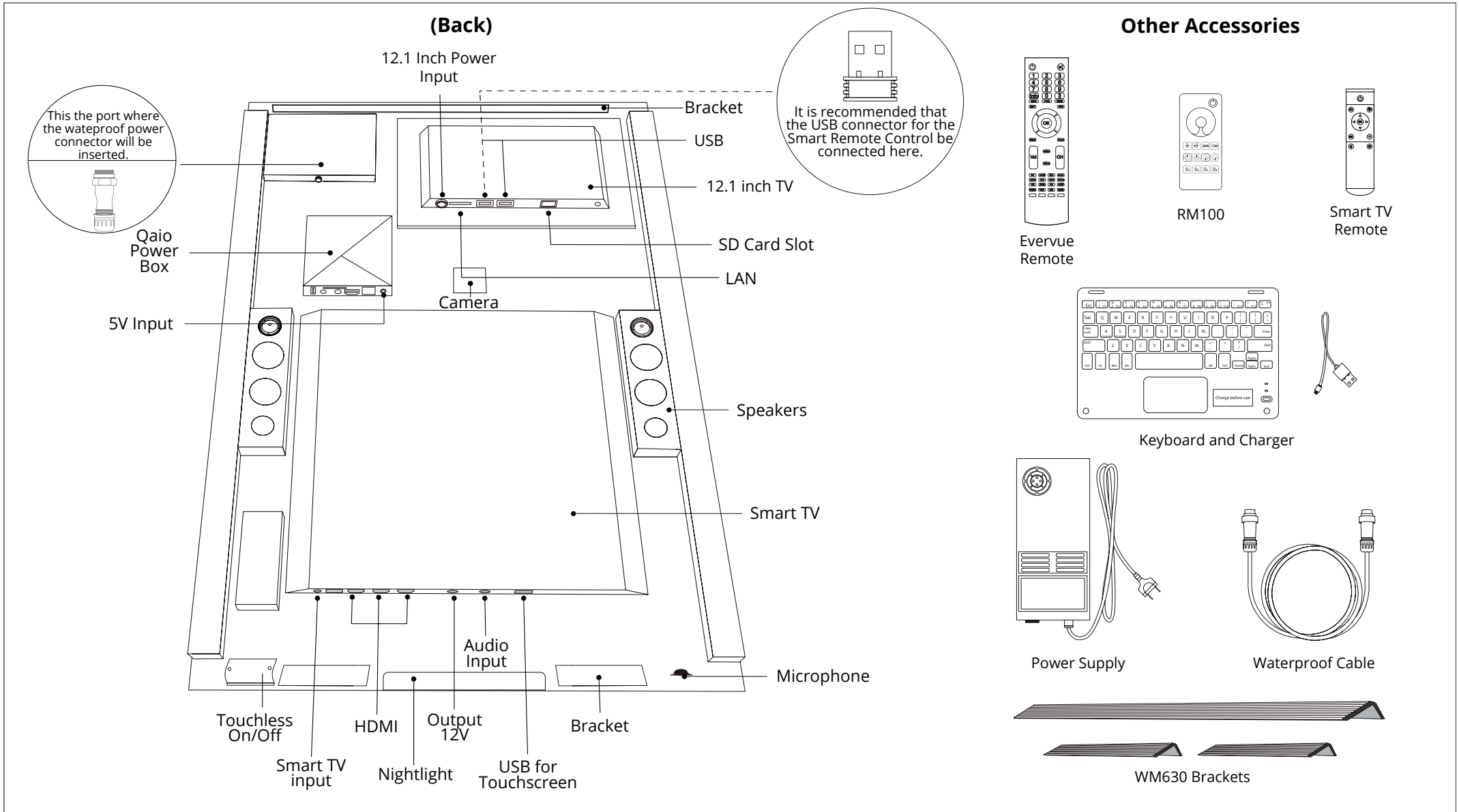

# QAIO PRODUCT MANUAL

QUICK LINKS  
(CLICKABLE)



## Unboxing

Upon receiving your order, open the crate and inspect the contents. Damages must be reported within 24 hours.

(Front)

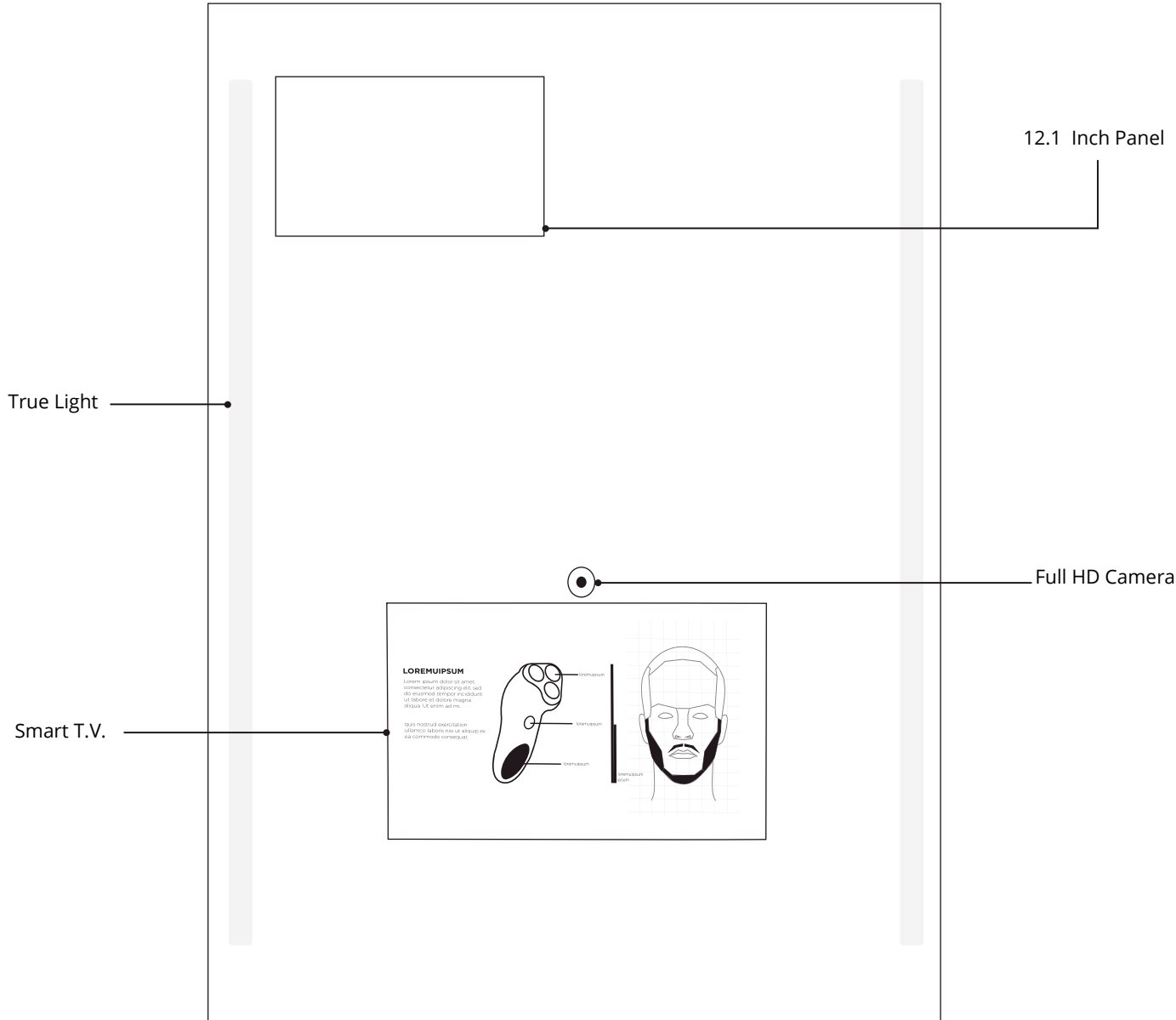

- Both of the TVs in the mirror completely vanishes when turned off.
- Aside from the camera, the mirror also has a built in microphone.
- The Qaio also has a built in ALEXA voice control.
- Qaio is powered with 24 volt DC. It is completely safe to use anywhere in the bathroom.
- Qaio is built with convenience in mind, it can be installed in under 30 minutes.
- It also has a motion sensor that automatically turn the lights off after five minutes of being idle.
- The power cords used for Qaio are heavy duty and waterproof to ensure safety in the bathroom.

Front

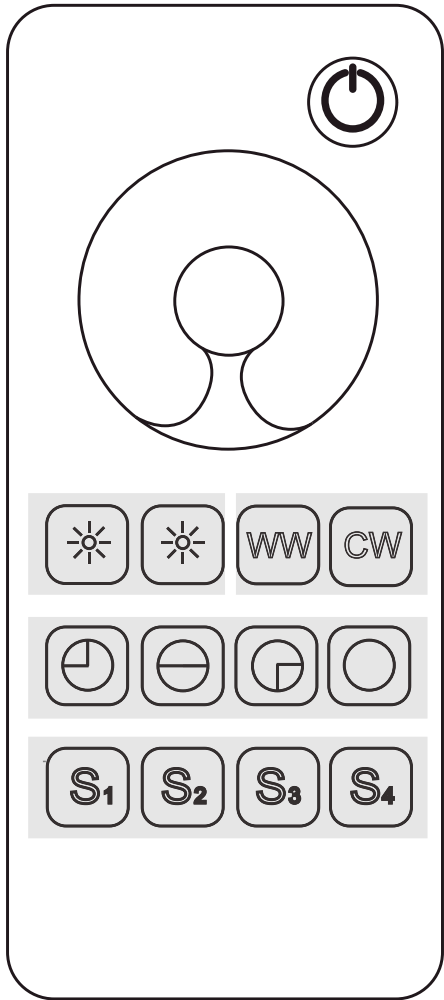

Back

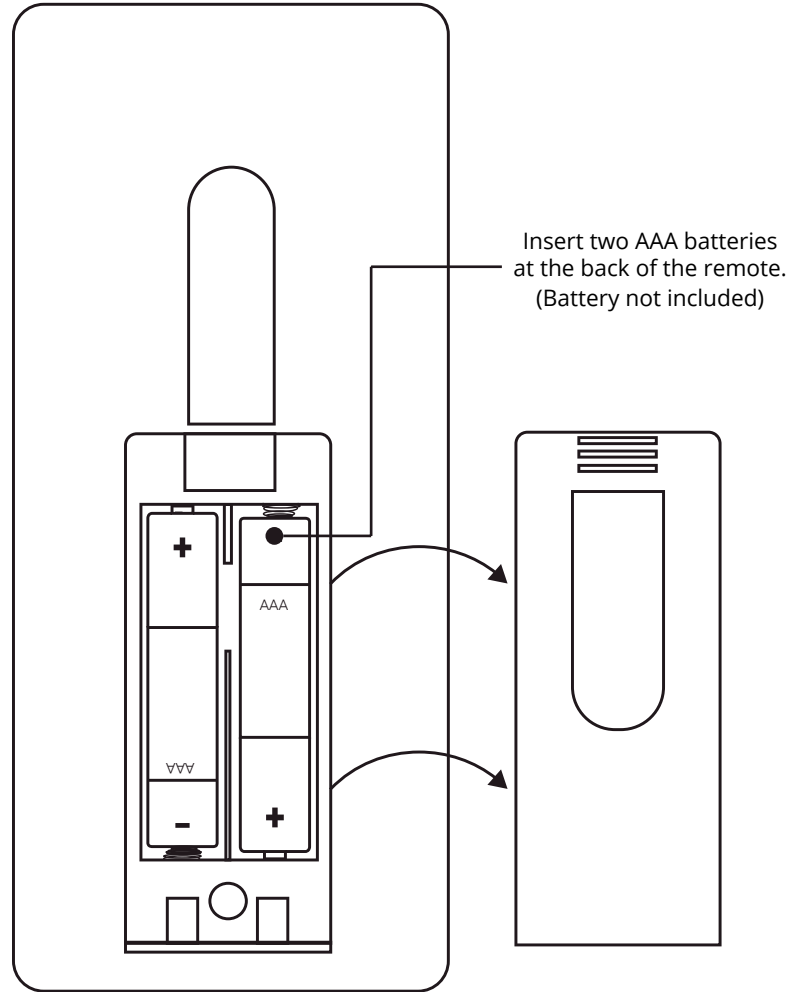

	Power Button
	Touchpad changes the color temperature of the mirror from warm to cold.
	Adjusts the lights' level of brightness. The left button reduces the amount of light by 10% and the right button brightens it by 10%.
	Changes the light temperature to warm or cold.
	Adjusts the lights 25%, 50%, 75% and 100% brightness respectively.
	Saves the current settings of your mirror. You can save up to four settings.

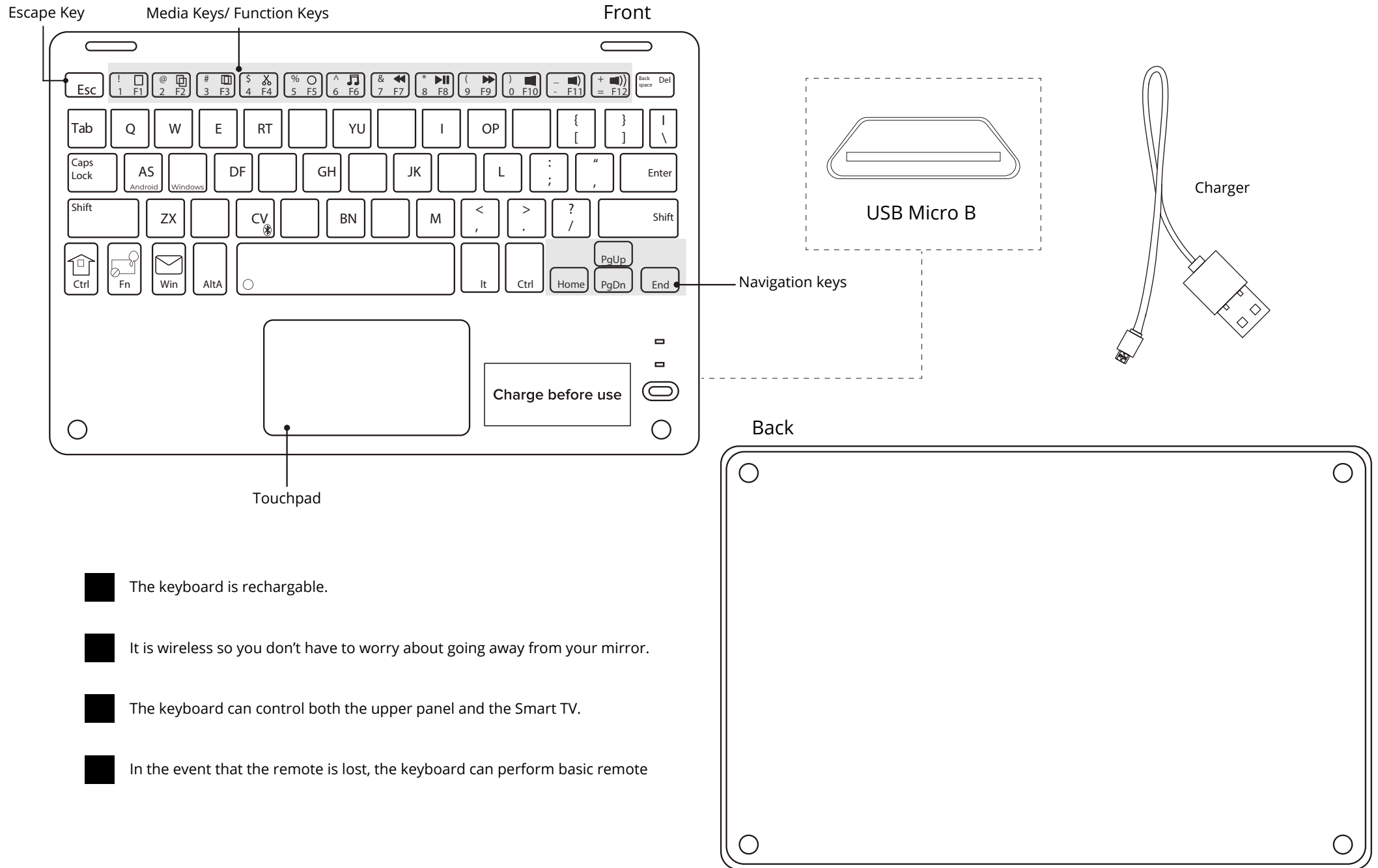

- The keyboard is rechargeable.
- It is wireless so you don't have to worry about going away from your mirror.
- The keyboard can control both the upper panel and the Smart TV.
- In the event that the remote is lost, the keyboard can perform basic remote

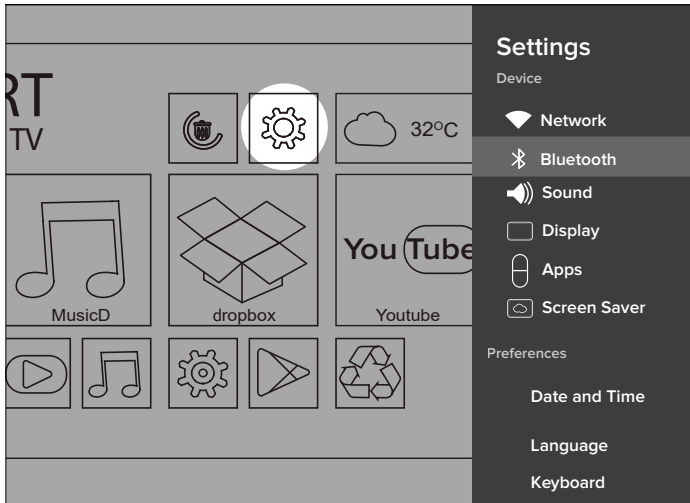

**1 Connect via bluetooth**  
Go to the settings of your mirror and go to bluetooth.

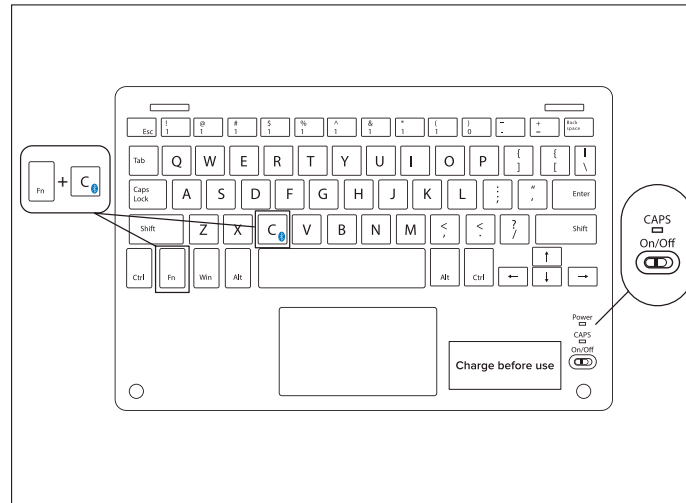

**2 Pair up the keyboard to the TV**  
Turn the Keyboard on. Then press the FN+C button to make it discoverable. Initially, the CAPS blue light will turn on if the keyboard is still pairing, once done, it will turn off.

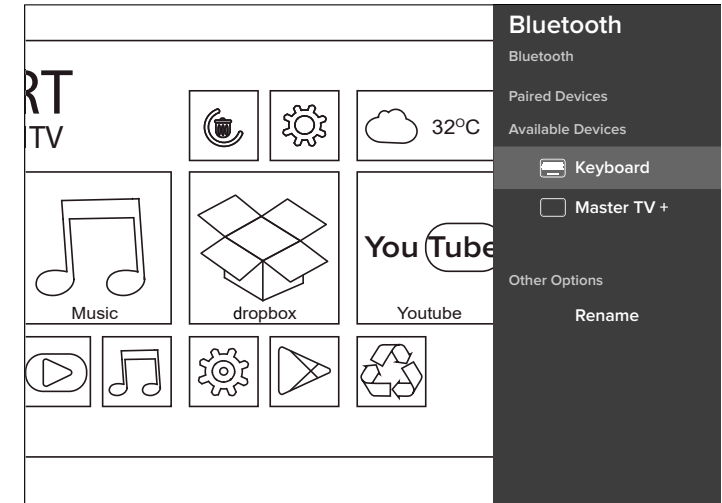

**3 Finish pairing up**  
On your TV, click the keyboard under the list of available devices to pair it up.

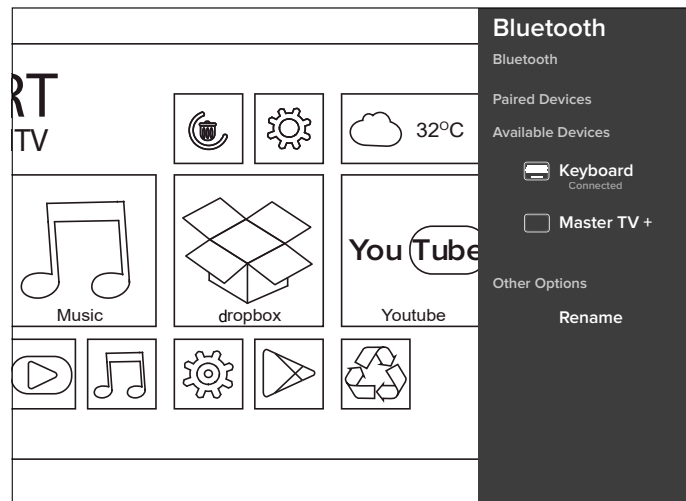

**4 Done**  
Once you see the word "connected" under the keyboard name, your device is ready to use.

**Note** Charge the wireless keyboard before using it.  
The power light will be red while the keyboard is charging and yellow when its done.

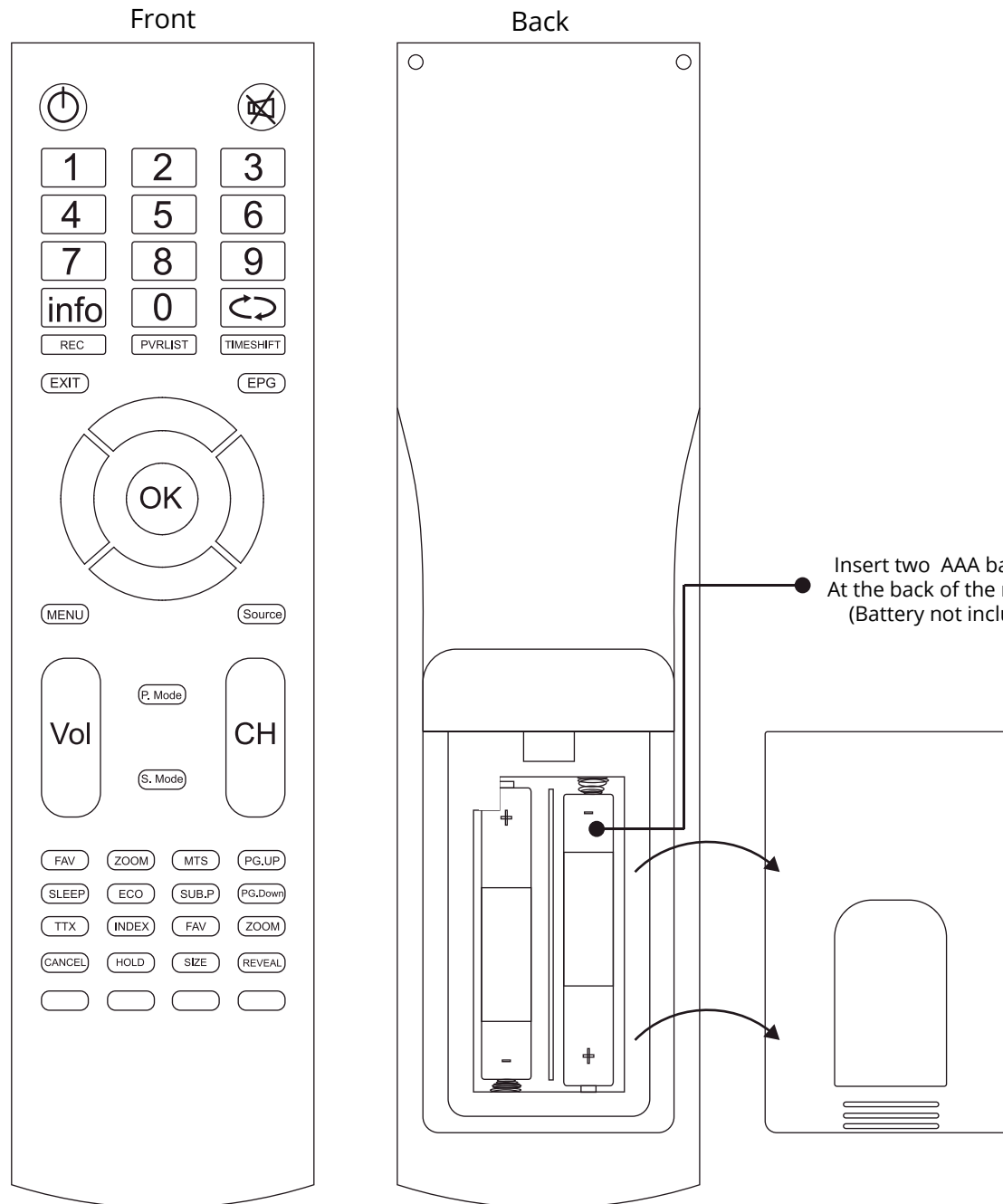

- The remote controls the Smart T.V.
- What could you do with this remote?

- Change the brightness and color of the screen
- Change the HDMI input
- Increase the audio volume of the T.V.
- several more advanced settings

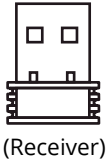
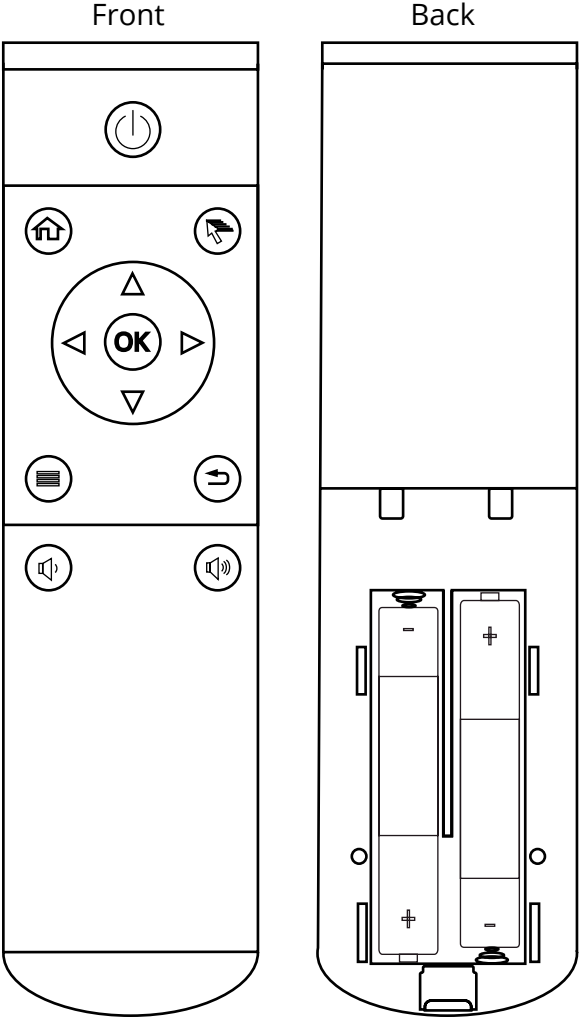

(Receiver)  
This receiver connects the mirror to the remote. It is inserted at the back of the mirror.

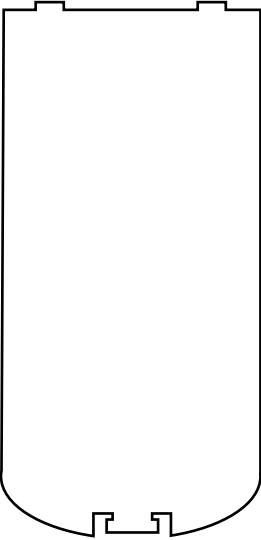

Insert two AAA batteries  
At the back of the remote.  
(Battery not included)

	Power Button
	Press this to go back to main screen.
	Press this button to point and click on the screen.
	Press this to bring up the T.V. Settings.
	Press this to go back to the page that was previously displayed.
	Press this to raise the volume up.
	Press this to lower the volume down.



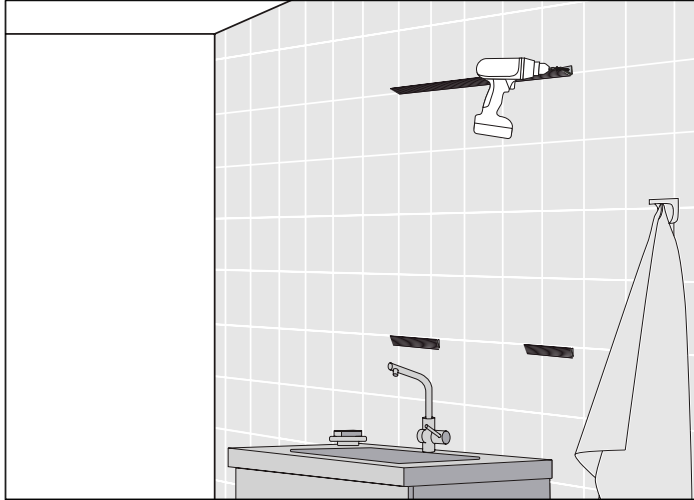

**1 Attach the Brackets to the Wall**  
Screw the mounts to the wall.

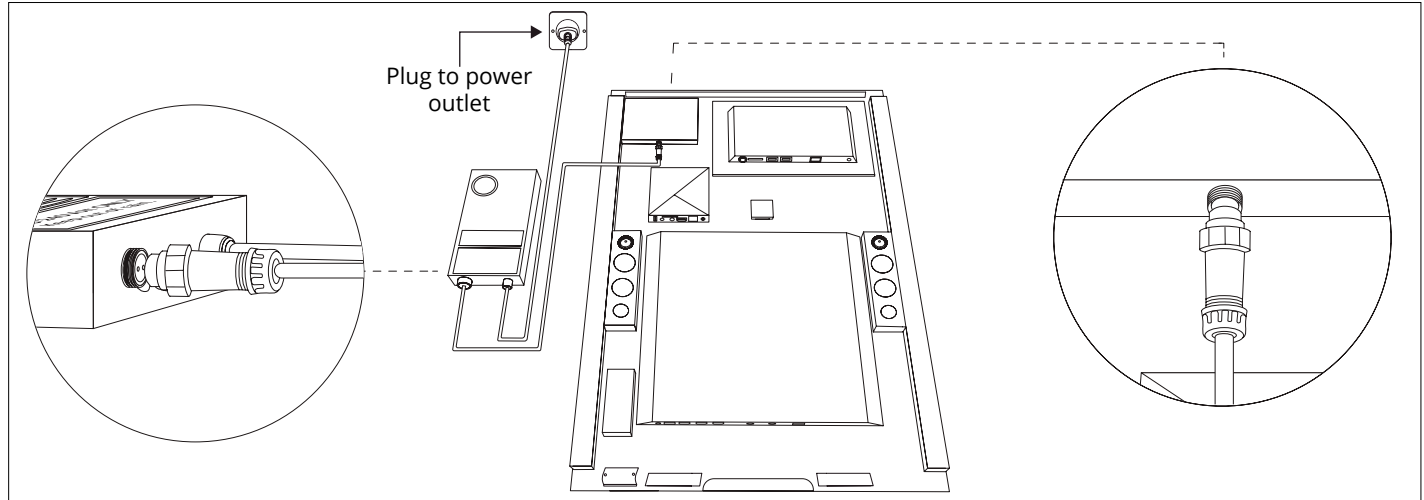

**2 Plug to a Power Source**  
Connect the mirror to a power source.

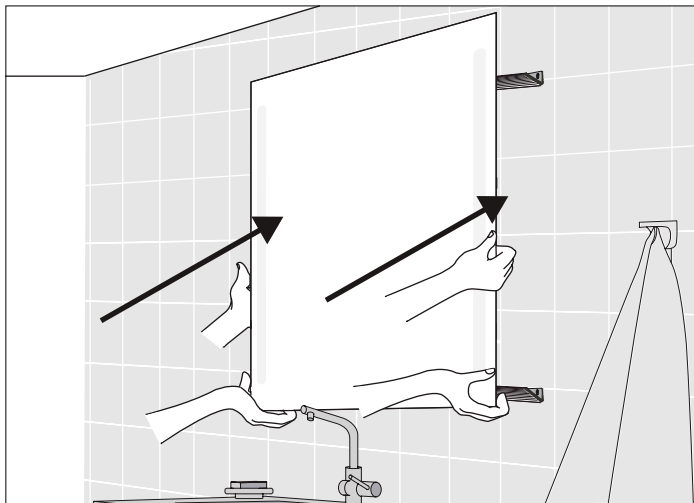

**3 Hang the Mirror**  
Hang the mirror to the wall mounts you installed on the wall.

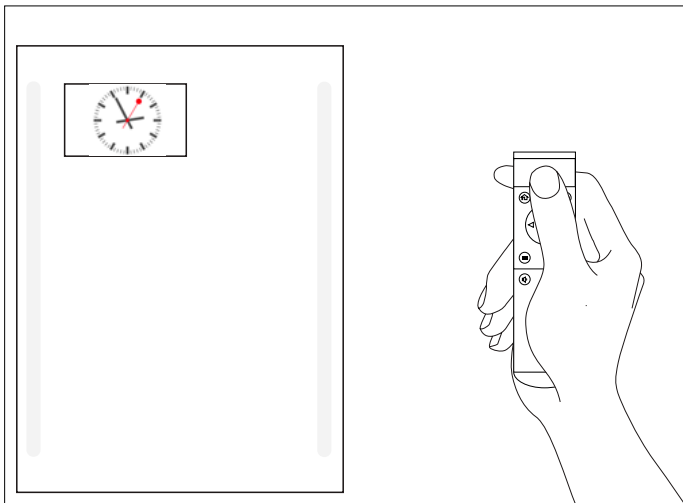

**4 Turn on the 12.1 Inch Panel**  
Turn the 12.1 inch panel on by pressing the power button on the smart remote control

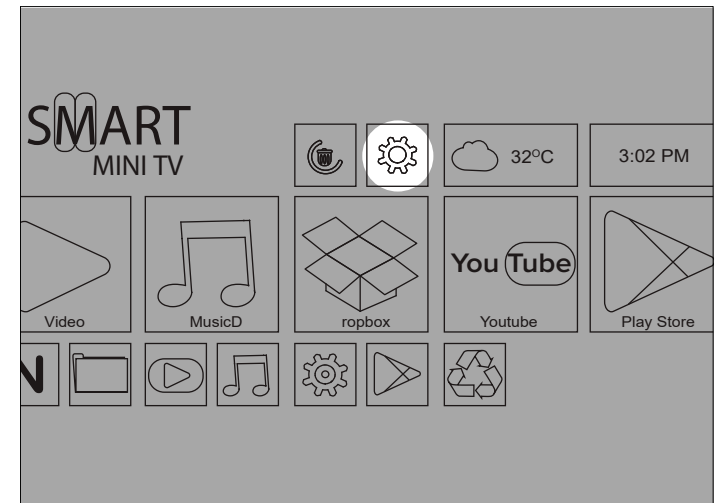

**5 Connect to the Internet**  
Once the screen is on. Click on the icon that looks like a gear. This will open up the settings menu where you can connect to the internet.

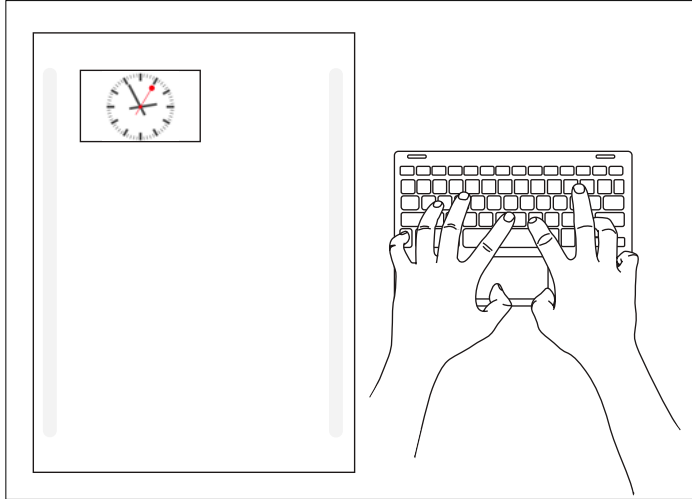

**6 Manage and Personalize**  
Use the keyboard to install and control smart apps.

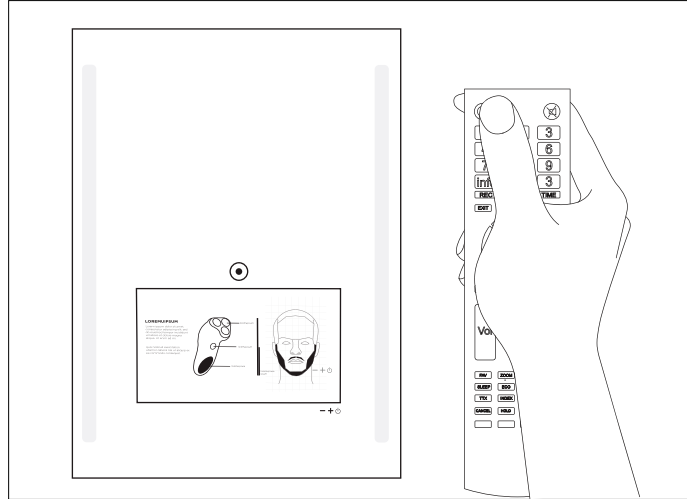

**7 Turn on the TV**  
Turn on the the Smart TV by pressing the power button located on the top left portion of the Evervue Remote.

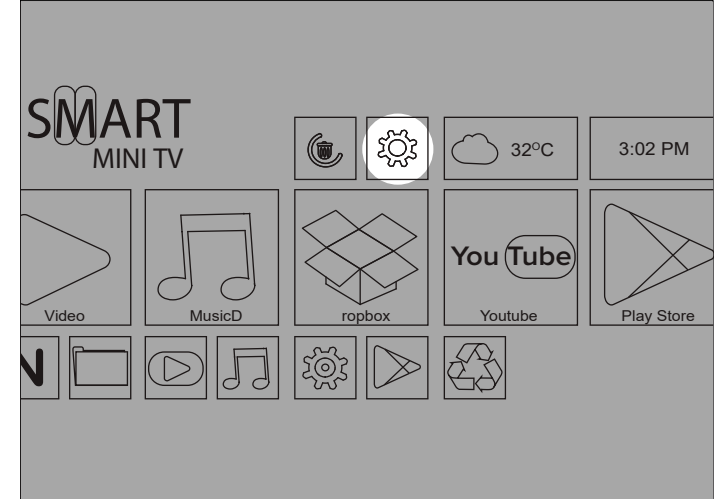

**8 Connect to the Internet**  
Again, find the gear icon and connect to the internet.

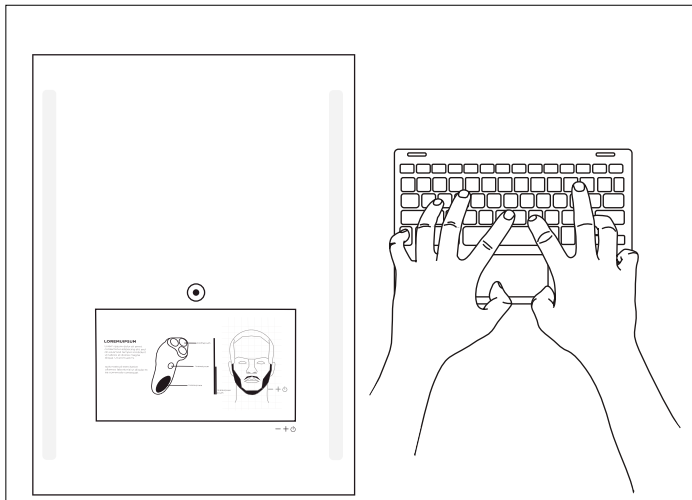

**9 Manage and Personalize**  
Use the keyboard to install and control smart apps. The Smart TV is also touch screen.

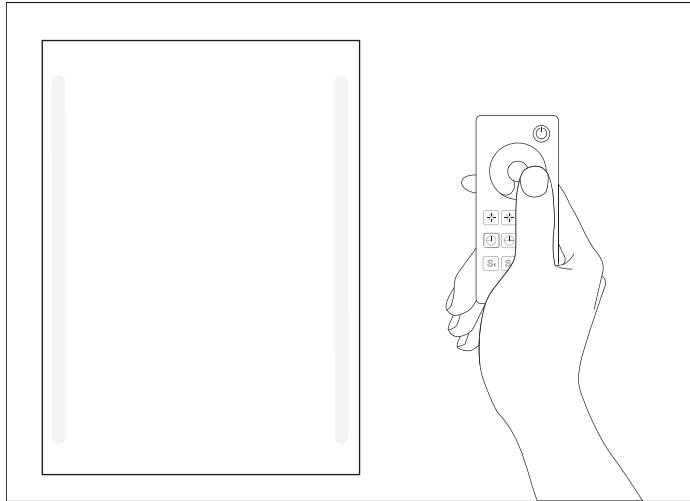

### Option 1

The mirror lights can be controlled using the RM100 remote control included in the box.

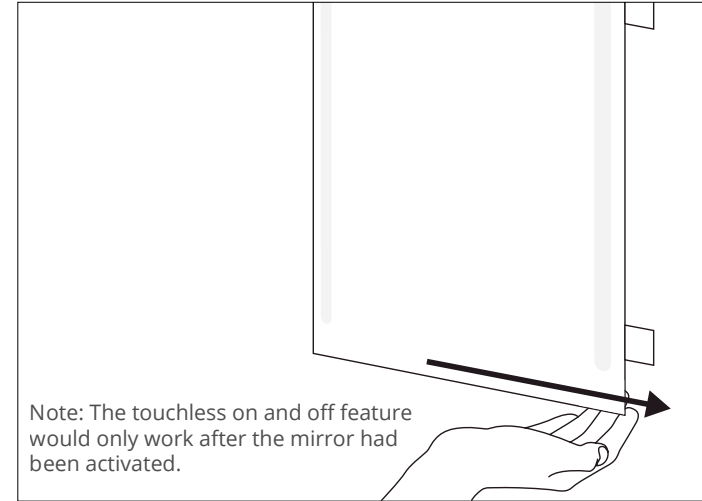

### Option 2

The mirror also has a touchless on and off feature. Simply wave your hand under the bottom right side of the mirror to turn the lights on and off.

## Qaio Mirror - How To Install Apps

Option 1: Download the APK Online



### 1 Download the APK

Download the APK online.

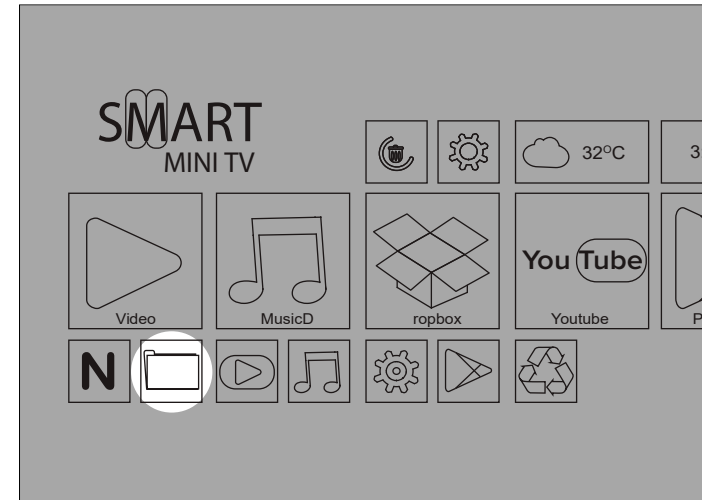

### 2 Install the App

Once the download is complete, Go to "File Manager" and find the APK you downloaded. Click it and it will be installed.

# Qaio Mirror - How to Install Apps

Option 2: Download from the Google Play Store

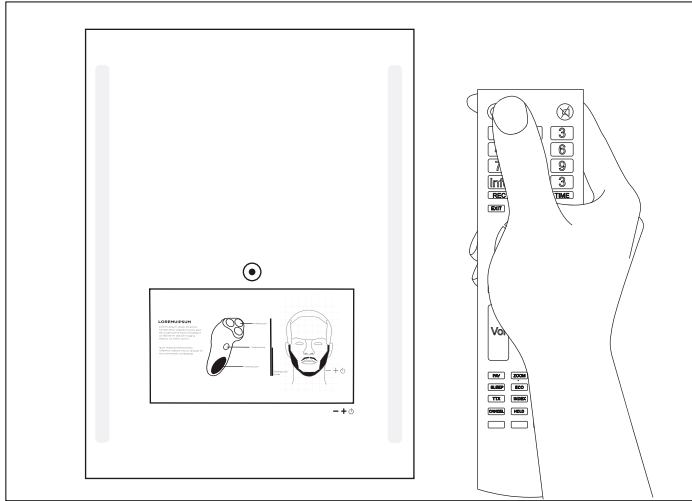

## 1 Turn on the TV

Turn on the the Smart TV by pressing the power button located on the top left portion of the Evervue Remote.

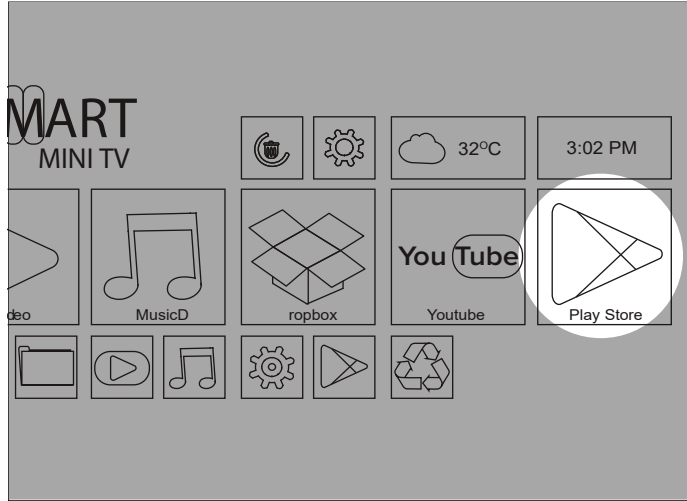

## 2 Click the Play Store icon

Go to Play Store.

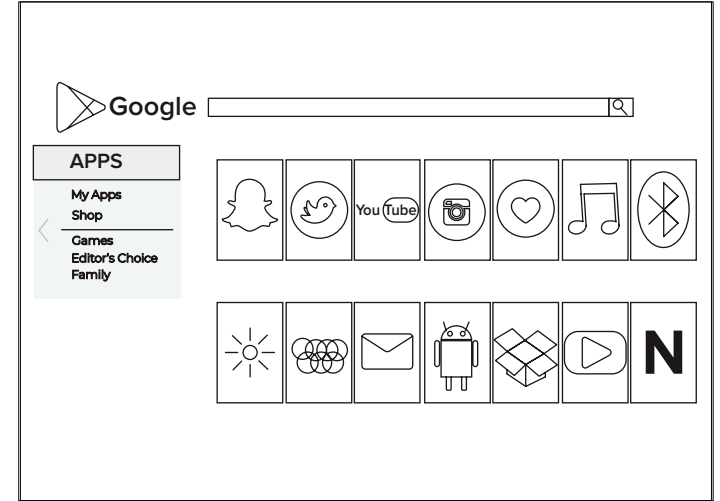

## 3 Browse

Find the app that you want and download it.

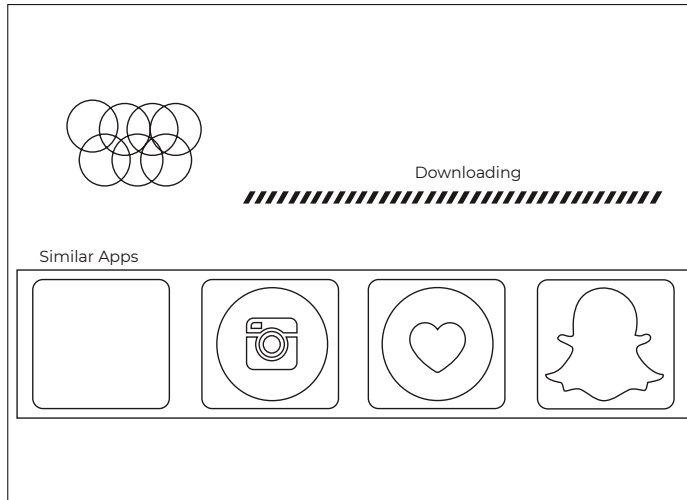

## 4 Install

Click install and wait for it to finish downloading.

# Qaio Mirror - How to Adjust Settings for the Nightlight

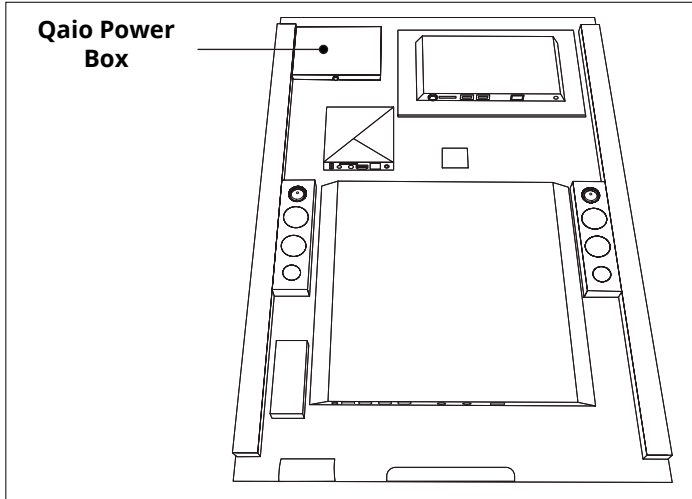

- 1 Take the box from the back of the mirror**  
Find the Qaio power box on the top left corner at the back of the mirror.

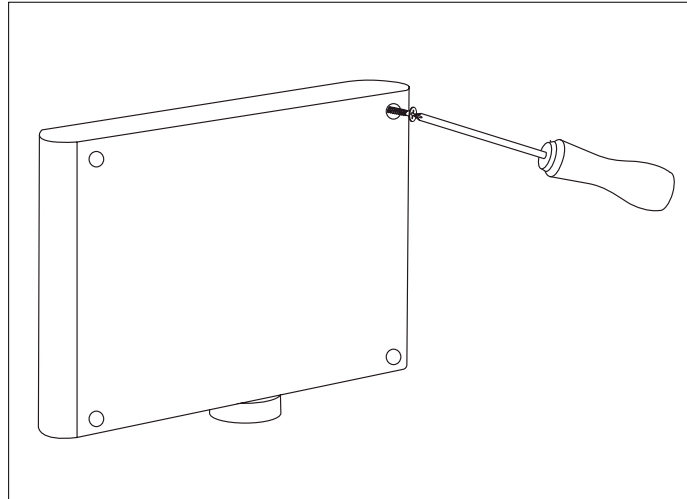

- 2 Remove the Cover of the Qaio Power Box**  
Use a screw driver to remove the cover of the qaio power box.

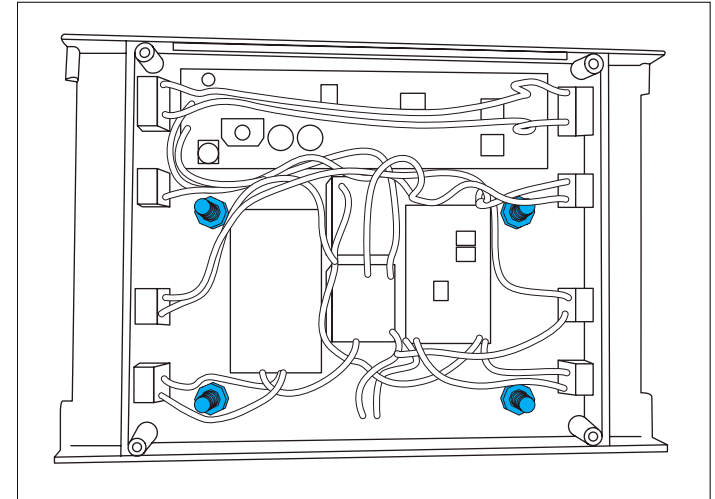

- 3 Remove the Screws**  
Remove the inner box by unscrewing the bolts shaded in blue.

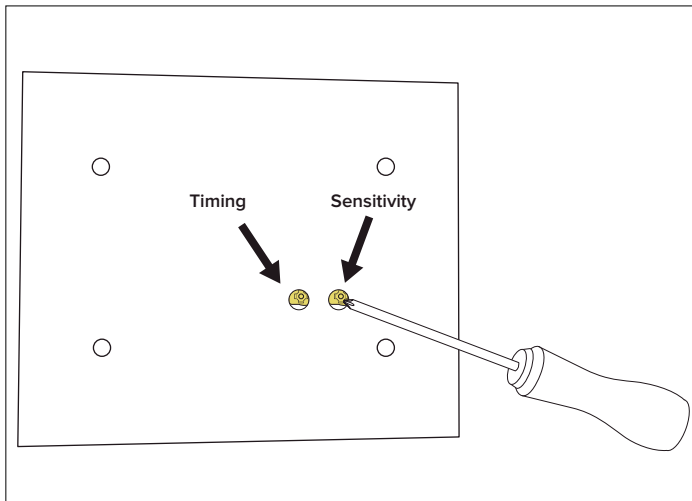

- 4 Adjust to Taste**  
Flip the inner box. Using a screwdriver, twist the left adjustment screw to adjust the timing and the right for sensitivity.

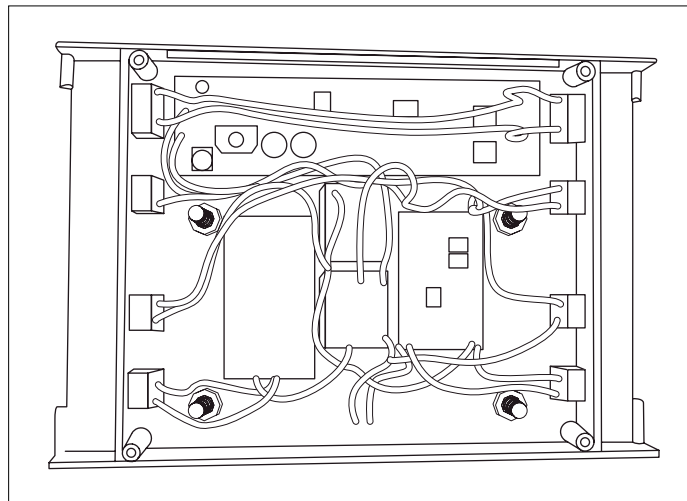

- 5 Assemble the Power Box Back Together**  
Put the inner box back to its case.

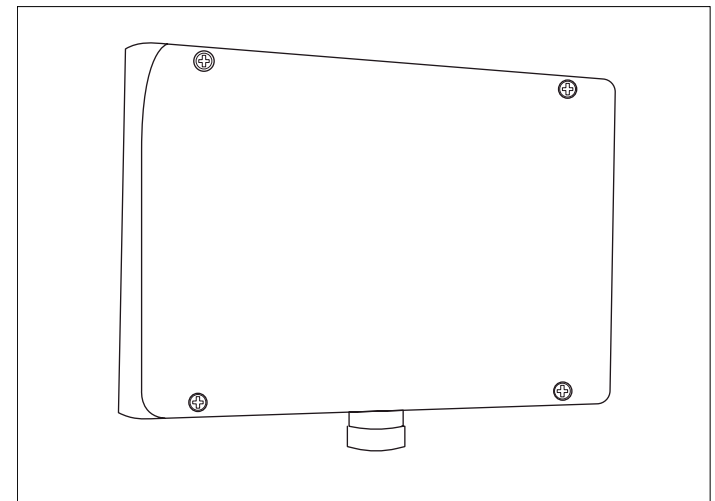

- 6 Done**  
Cover the qaio power box up and securely tighten its screws.

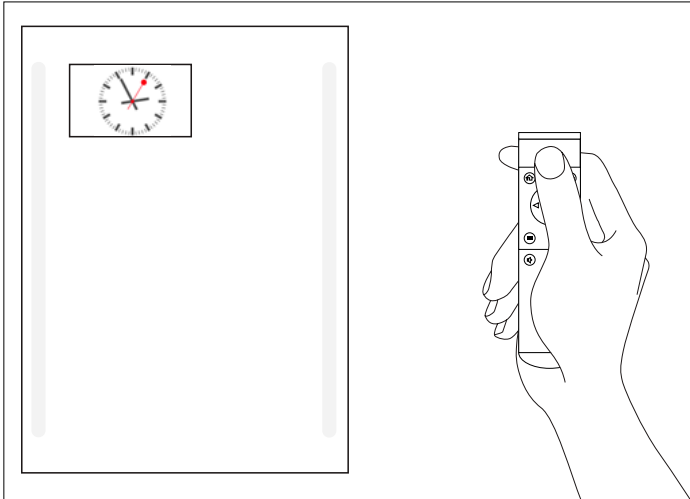

## 1 Turn on the 12.1 inch panel

Press the power button on the 12.1 Inch TV remote to turn on the 12.1 inch panel.

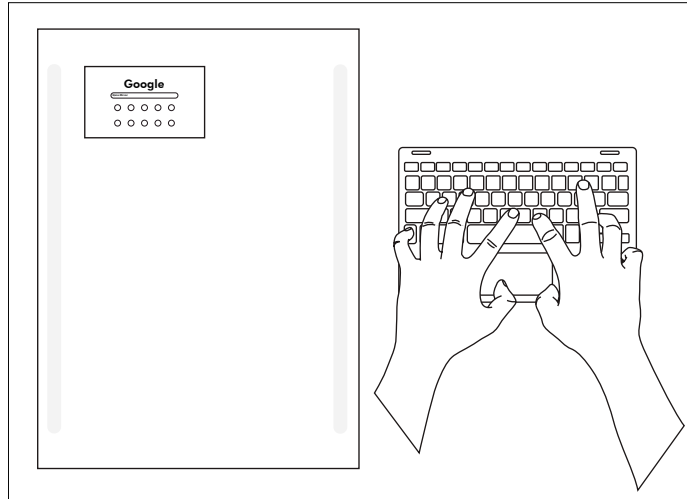

## 2 Go to the MyQaio website

Open the browser and go to <https://www.myqaio.com/faq> and click the download category.



## 3 Download

Download the APK file on the page.

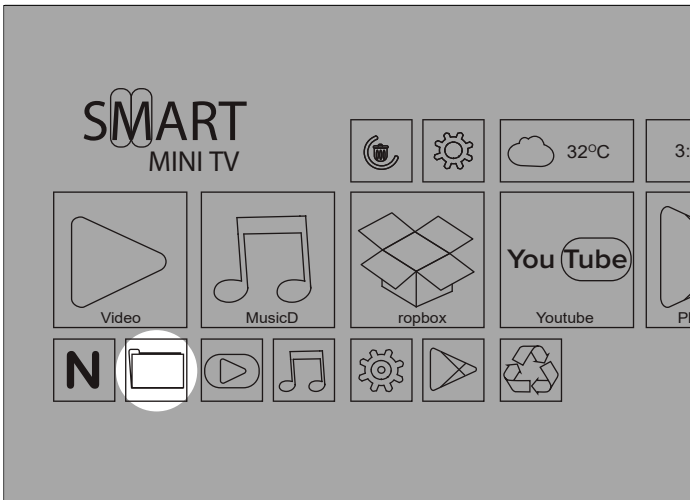

## 4 Go to File Manager

After the download is complete, go back to the main screen by pressing the "ESC" key on the keyboard, then go to "File Manager".

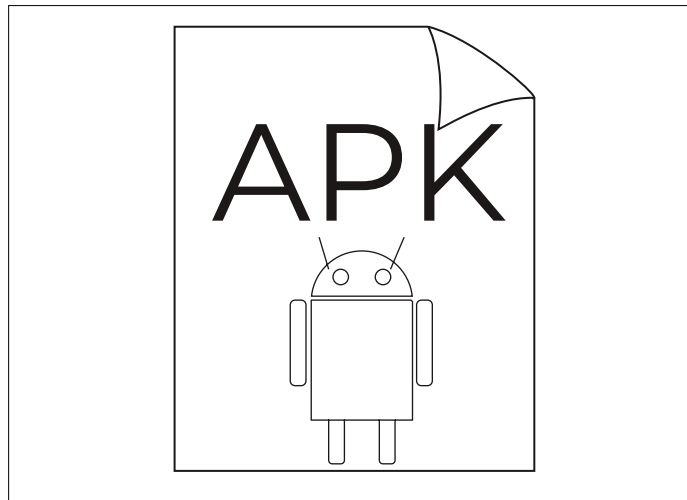

## 5 Install APK

Go to "Local Disk", and then click "Downloads". Find the file "MirrorFeed.apk" and double click it to install.

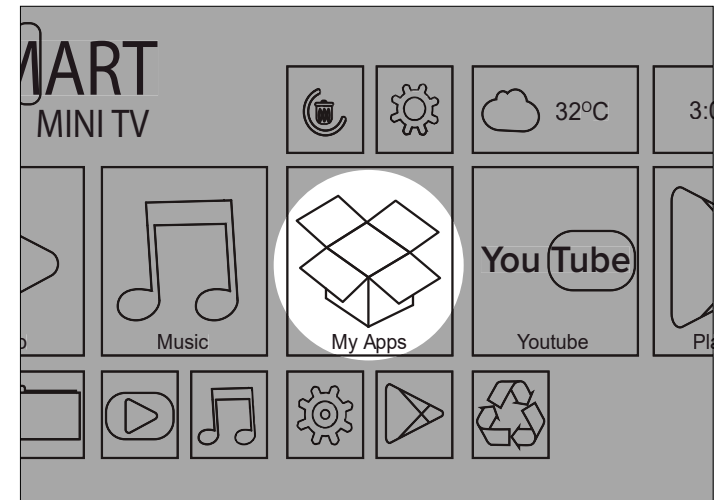

## 6 Launch

After the installation is complete. Go back to the main screen and launch the app.



- 1 Go to Settings**  
Click the gear icon found on the lower right side of your screen.

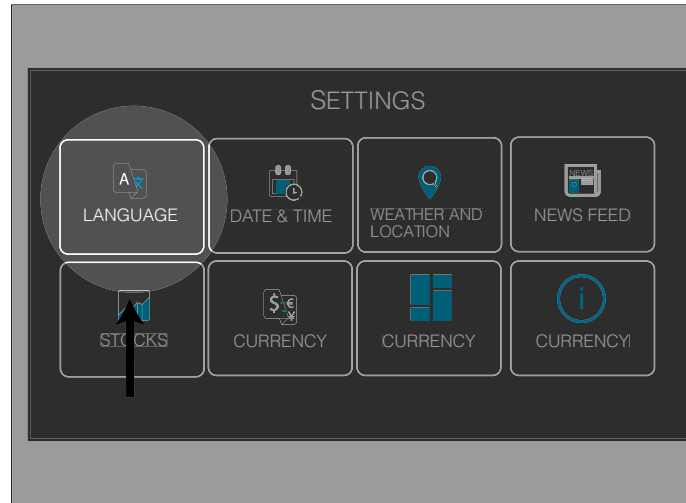

- 2 Click Language**  
Click the language icon located at the top left side of the screen.

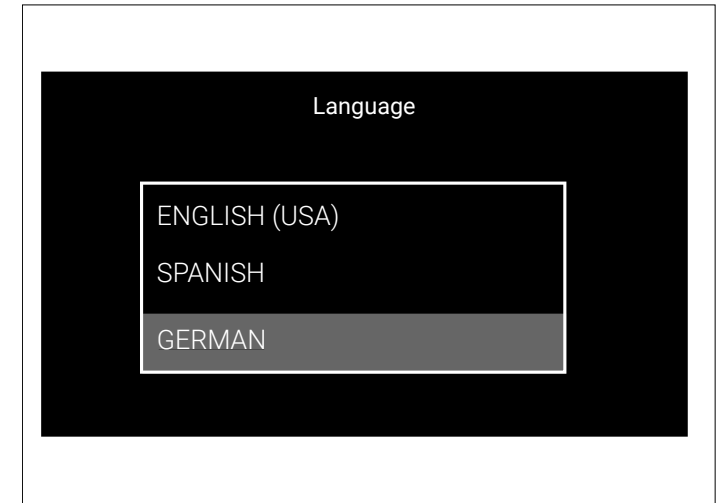

- 3 Choose your language**  
Choose your desired language.

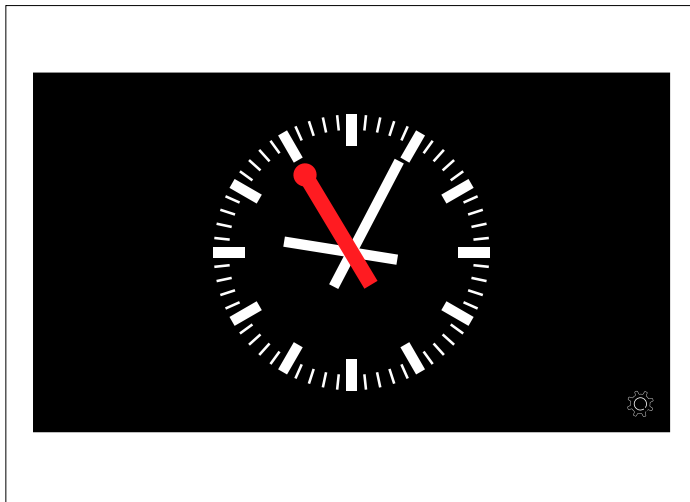

- 4 Done**  
Your MirrorFeeds app is ready to use.

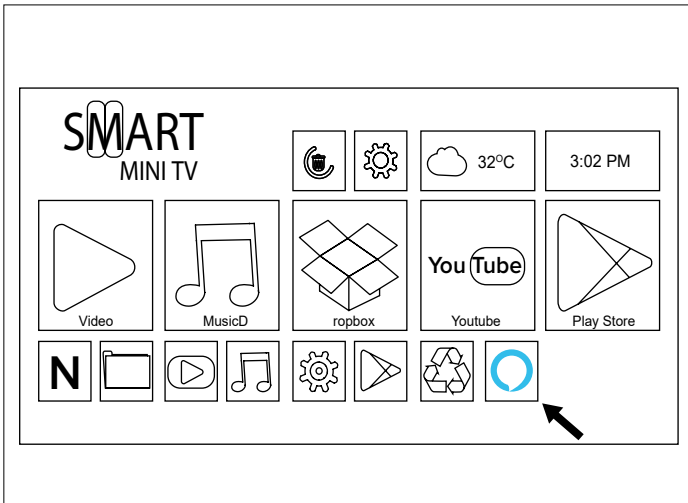

**1 Click the Alexa Icon**  
On your home screen, click the Alexa icon.

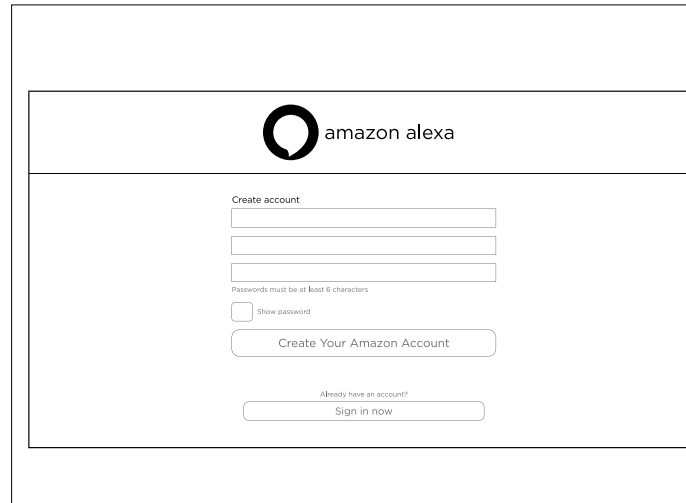

**2 Sign in or Register**  
Sign in with your amazon account or create a new one. Have your cellphone ready because a phone verification will be required to complete the setup.

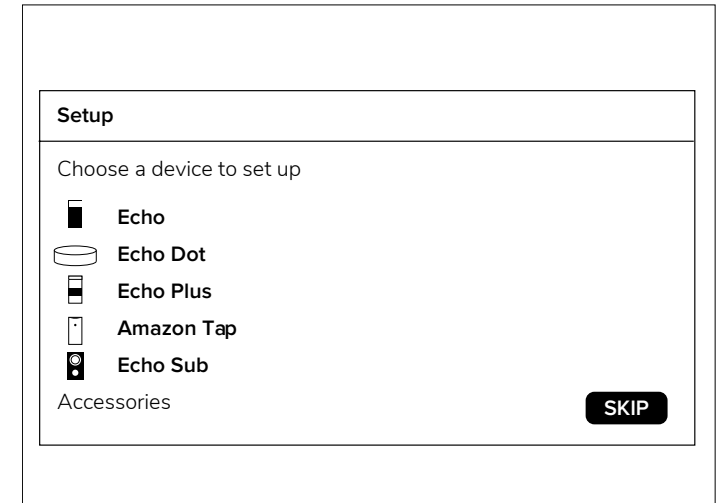

**3 Setup Alexa**  
If you have amazon devices at home, connect them to the TV by clicking them on the list, otherwise, click "SKIP".

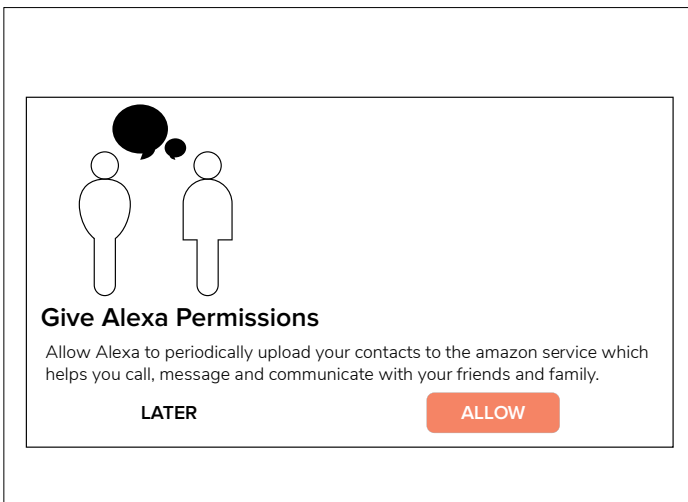

**4 Let Alexa access your device**  
In order for Alexa to assist you better, it will ask for permission to fully access your device and your data. Click "ALLOW" to agree and "LATER" to disagree.

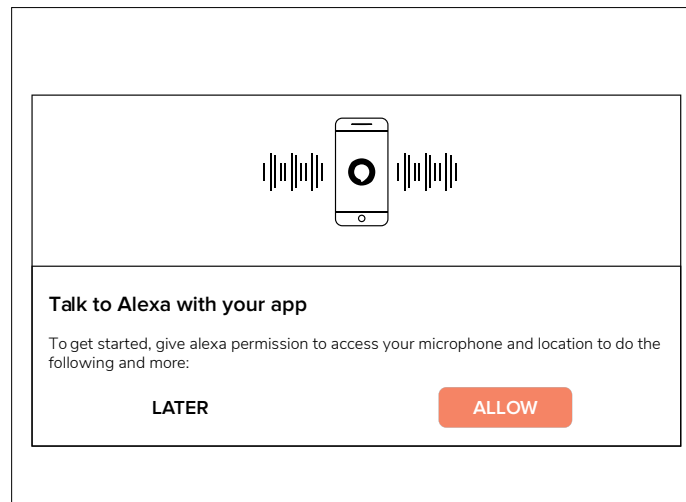



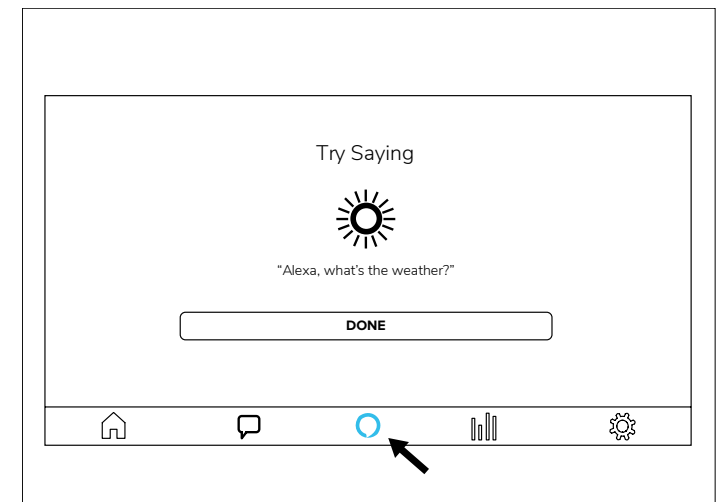



**5 Enable Microphone and Location**  
It is important for Alexa to access the device's microphone and to know its current location. Please click "ALLOW" when asked for permission to access these two.



**6 Done**  
Done. Your Alexa is ready, click on the amazon Alexa icon and ask your question.



-  Mirror can be cleaned with alcohol 70%, turpentine oil and cloth.
-  Don't use Qaio outdoors.
-  The mirror is extremely fragile and can easily break or paints can easily chip off.
-  Always transport the mirror with care and at least 2 people.
-  Do not remove protective fill and corners from the mirror until mirror is installed.
-  Consult a licensed contractor for installation.

For updated information and troubleshooting please visit [www.myqaio.com](http://www.myqaio.com).